

25th EUROPEAN SYMPOSIUM ON RELIABILITY OF ELECTRON DEVICES, FAILURE PHYSICS AND ANALYSIS

ESREF 2014 Berlin, Germany

September 29 – October 2, 2014, Technische Universität Berlin



Call for Exhibitors

> INVITATION TO EXHIBIT

At the **ESREF 2014** conference to be held in Berlin from September 30 - October 2, 2014, exhibition space will be provided for related products and services in the field of reliability physics in electronics.

The **ESREF 2014** will provide a venue for business and non-profit organizations to make contact with the international community on reliability of electron devices, failure physics and analysis (approx. 250 participants).

Potential exhibitors should contact the organizer (address overleaf) for further information.

> WHY EXHIBIT?

The **ESREF 2014** conference and exhibition attracts influential decision makers who attend the technical sessions to present their work and learn about the latest technological developments.

While they come to network with colleagues and peers, they will automatically visit the exhibition.

As an exhibitor, you will have the unique opportunity to get in on the ground floor and market your products and services to a captive audience of buyers, designers and influencing researchers. Exhibit hours have been arranged to give exhibitors maximum exposure. Social functions have been planned in the exhibit area so that delegates meet on both a social and business level.

> EXHIBITORS ADMISSION POLICY

Exhibiting companies or organizations are required to meet the following criteria:

- The company must be engaged in the design, development, manufacturing, marketing, distribution, exploitation, operation or servicing of reliability of electronics equipment as its principal business or maintain a department or division devoted to this work.
- The company must offer products or services for sale direct to consumers or operators. Any exceptions to this policy will be reviewed by the **ESREF 2014** management committee which retains the right, in its sole discretion, to refuse or deny any application submitted, in which case any payment shall be returned.

> BOOTH SPACE RENTAL

370,- €/sqm + 19% (VAT) before June 30, 2014
420,- €/sqm + 19% (VAT) after June 30, 2014

Space cost includes:

- Rental of space
- Booth with name banner
- General illumination
- Security service

- One table and two chairs
- General clean-up
- One free conference entrance (all services excluding conference dinner)
- Your logo will be published on the website
- reduced exhibition badge available (includes the conference attendance, catering during the conference and the welcome reception, not the conference dinner)

Please note that all registrations of booth personnel to attend the conference must be purchased separately. Registrations for the full conference must be completed using the official registration form or using the online registration at: www.esref2014.org

Please note:

Exhibitors sending wire transfers from outside Germany please include a 25.00 EUR bank fee for the wire transfer.

> EXHIBITION SPACE FEES

Equipped exhibition space at the **ESREF 2014** conference and exhibition is available from 6 sqm and increments thereof as shown in the attached floor plan. Single booth spaces may be combined to form larger booths. Booth space will be sold on a first come, first served basis upon receipt of the application and contract for exhibition space with full payment.

Exhibitors are encouraged to reserve booth space no later than June 30, 2014 to take advantage of the early bird discount.

> EXHIBITION HOURS

Set up will be on September 29, 2014

Tuesday, September 30, 2014 08:30 - 17:00
Wednesday, October 1, 2014 08:30 - 17:00
Thursday, October 2, 2014 08:30 - 18:00

Exhibit hours may change slightly after the technical program schedule is complete.

All sessions coffee breaks, lunch and welcome reception will be held in the exhibit hall's food service areas.

> LANGUAGE/INFORMATION

The official language of the conference is English. Latest information on the conference and exhibition will be provided on the **ESREF 2014** homepage at www.esref2014.org

> CONTACT

VDE Conference Service
Ms. Jasmin Kayadelen
Stresemannallee 15
60596 Frankfurt, Germany
Phone: +49 (0) 69 63 08 275
Fax: +49 (0) 69 63 08 144
E-mail: jasmin.kayadelen@vde.com

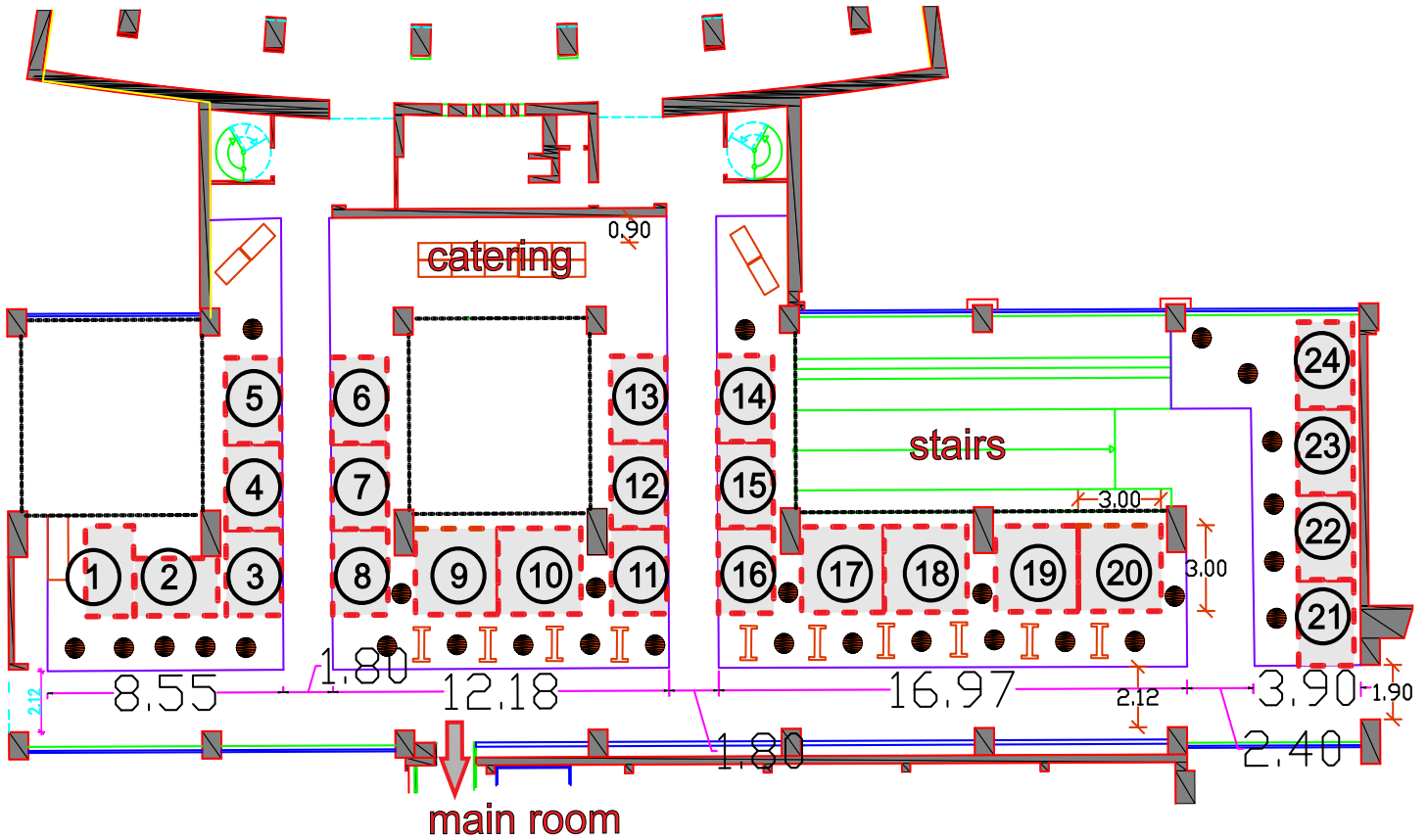

With the technical co-sponsorship of:

- IEEE - Electron Devices Society
- IEEE - Reliability Society
- IEEE - Components, Packaging, and Manufacturing Technology Society
- EUFANET - European Failure Analysis Network



in conjunction with:



organised by:

