

### Exhibition Plan

- 2 x 3m = 6m<sup>2</sup>
- 3 x 3m = 9m<sup>2</sup>

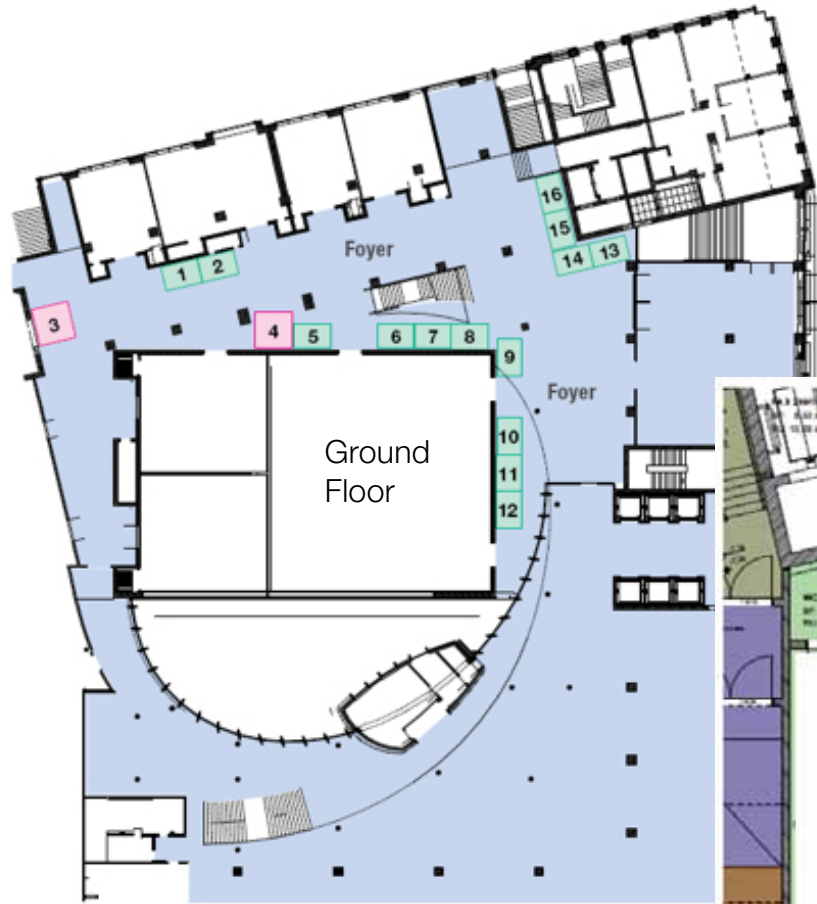

Technically Co-Sponsored by

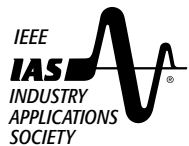

## International Conference on Electrical Machines

Andel's Hotel Berlin, Germany  
September 2-5, 2014

[www.icem2014.de](http://www.icem2014.de)

Call for Exhibition



## ICEM'2014

### EXHIBITION AND PARTNERSHIP

This unique international event will bring together more than 500 participants from around 50 countries. The exhibition (from September 2 to 5) will allow you to promote your company, present your latest products and create privileged contacts within this unique gathering of scientists and engineers (including young graduates to be hired) from all around the world.

Attendees of ICEM'2014 want to see your solutions! Others may want to join your staff or advance their skills through your programs or specific events. Exhibit at this conference and you will meet them all.

Take advantage of this rare opportunity when academia and industry join together for this major event! Deadline to contract is **June 20, 2014**.

### Who should exhibit?

- Manufacturers
- Solution providers
- Software vendors
- Educational material providers
- Recruiters (if you are looking for future industry leaders among graduate students of major universities worldwide)
- Publishers (Technical publications – Professional journals – Educational books)
- Different solutions will be proposed from a standard booth and to a real conference partnership

### Exhibit space and cost

Space Cost Per m<sup>2</sup> (before June 30<sup>th</sup>, 2014) 240,- €  
 Space Cost Per m<sup>2</sup> (from June 30<sup>th</sup>, 2014) 280,- €  
 Additional equipment such as electric connection and furniture can be ordered separately at VDE Conference Services. Prices are subject to 19 % VAT)

In the exhibition fee the participation to ICEM 2014 of one person per Exhibitor is included. No unit stalls are demanded by the organizers. In the context of the rented space individual objects can be built (in agreement with the hotel). The outer dimensions of the escape routes may in no case be exceeded. The wishes of the issuer regarding the booth place and size will be considered in accordance with the available space. The organizer reserves however the right, even in retrospect to allocate another booth space.

### Topics

1. Classical rotating field machines
2. Innovative machines and actuators
3. Electrical drives
4. Design and related problems
5. Condition monitoring, diagnosis and testing
6. Embedded applications
7. Grid-connected or emergency applications

### Registration

The registration form for the exhibition and information about the congress is available at [www.icem2014.de](http://www.icem2014.de)

Please note that registration of larger exhibition space is possible.



### Registration and Billing

Following your binding registration you will receive an invoice with confirmation of the booked booth. The invoice amount is due 14 days after invoicing. A cancellation is possible up to June 02, 2014 (minus 100,- € handling cost).

### Sponsoring

There are special offers for ICEM2014 sponsors. Are you interested?  
 Please contact VDE Conference Services  
 E-Mail: [christian.gross@vde.com](mailto:christian.gross@vde.com)  
 (phone ++49 69 6308 381)

### Your contact:

VDE Conference Services  
 Simone Mayer  
 E-Mail: [simone.mayer@vde.com](mailto:simone.mayer@vde.com)  
 (phone ++49 69 6308 282).

Prof. Dr. Martin Doppelbauer  
 ICEM'2014 Exhibition Program Chair  
 E-Mail: [martin.doppelbauer@kit.edu](mailto:martin.doppelbauer@kit.edu)